

133735_2E-EWR-MCJ-021560-DR-T-002003

Continued on Drawing No. 133735_2E-EWR-MCJ-020780-DR-T-002002

KEY PLAN

OS map data reproduced by permission of Ordnance Survey on behalf of HMSO, © Crown copyright 2015. All rights reserved. Ordnance Survey licence number 0100040892

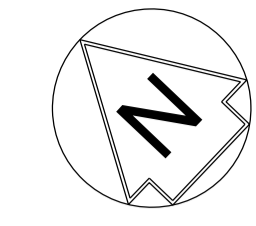

NETWORK RAIL (EAST WEST RAIL WESTERN SECTION PHASE 2) ORDER

KEY

	LIMIT OF HS2 FOOTPRINT
	HS2 WORK SECTION CENTRELINES
	EXTENT OF OVERLAP WITH ADJACENT SHEET

Continued on Drawing No. 133735_2E-EWR-MCJ-022360-DR-T-002004

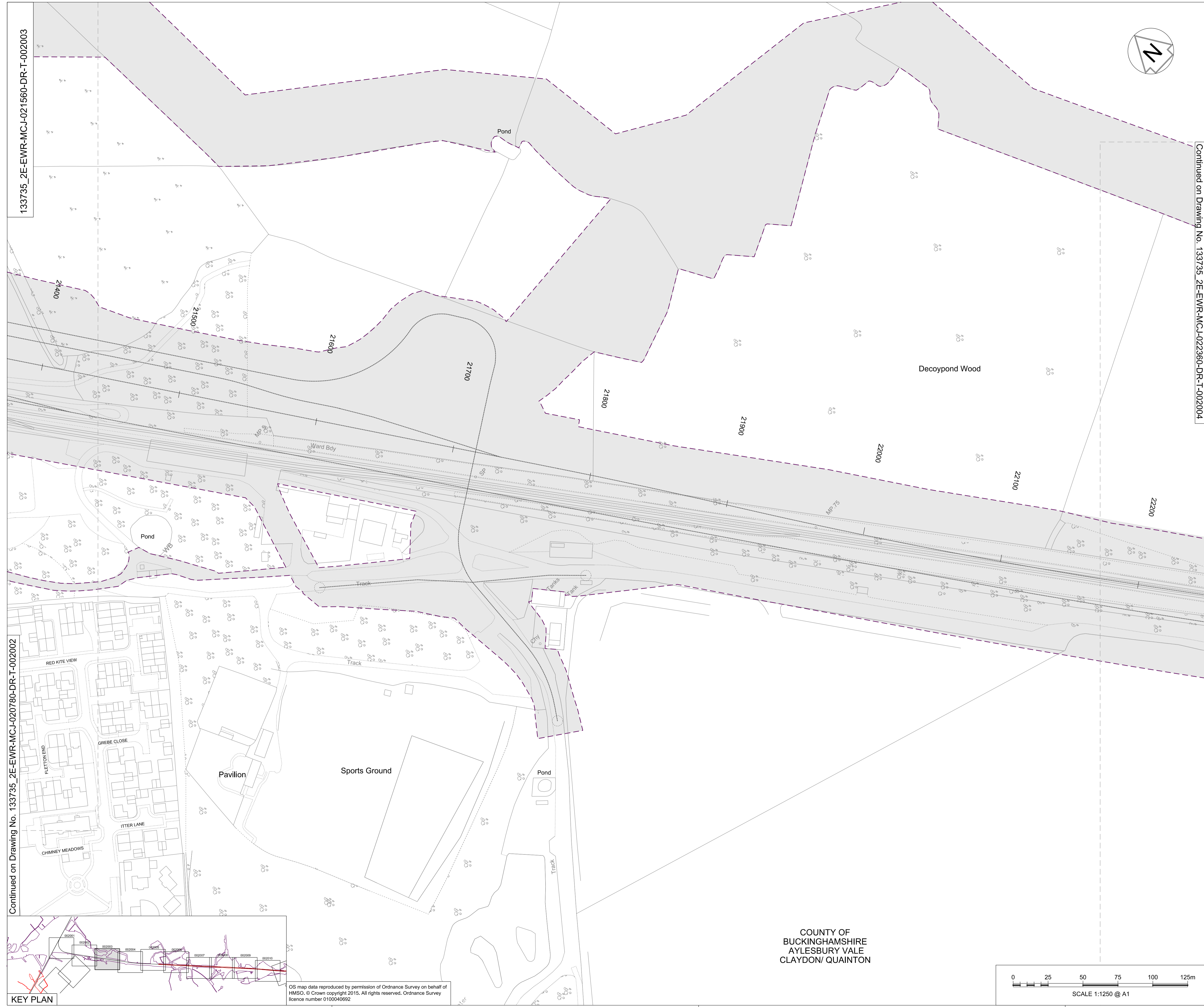

Rev	Date	Description of Revisions	Desd	Chkd	Appr	S.M.	P.P.	C.M.
A01	17/12/17	Approved for Consultation						
Status: Accepted for Outline Design						Suitability: A4		



Project
East West Rail (Western Section) Phase 2

Drawing Title
**Scheme Drawing
Aylesbury Vale - Claydon/ Quanton**

Designed	Sam McLelland	Signed	S. McLelland	Date	17/12/17
Drawn	Grace Newey	Signed	G. Newey	Date	07/12/16
Checked	Paul Panini	Signed	P. Panini	Date	17/12/17
Approved	Colin Murphy	Signed	C. Murphy	Date	17/12/17

Scale(s)
1:1250
ELR & Project Chainage
- 021560

Design Package Risk Classification
Normal

Alternative Reference
EWR2-CEP-DRG-PBL-452003

Drawing Number
133735_2E-EWR-MCJ-021560-DR-T-002003

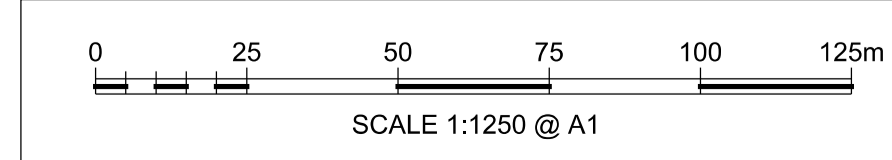

COUNTY OF
BUCKINGHAMSHIRE
AYLESBURY VALE
CLAYDON/ QUANTON