

Drawing Number
133735_2D-EWR-BBM-XXXXXX-DR-T-005023

COUNTY OF
BEDFORDSHIRE
CENTRAL
BEDFORDSHIRE
COUNCIL

Continued on Drawing No. 133735_2D-EWR-BBM-XXXXXX-DR-T-005022

KEY PLAN

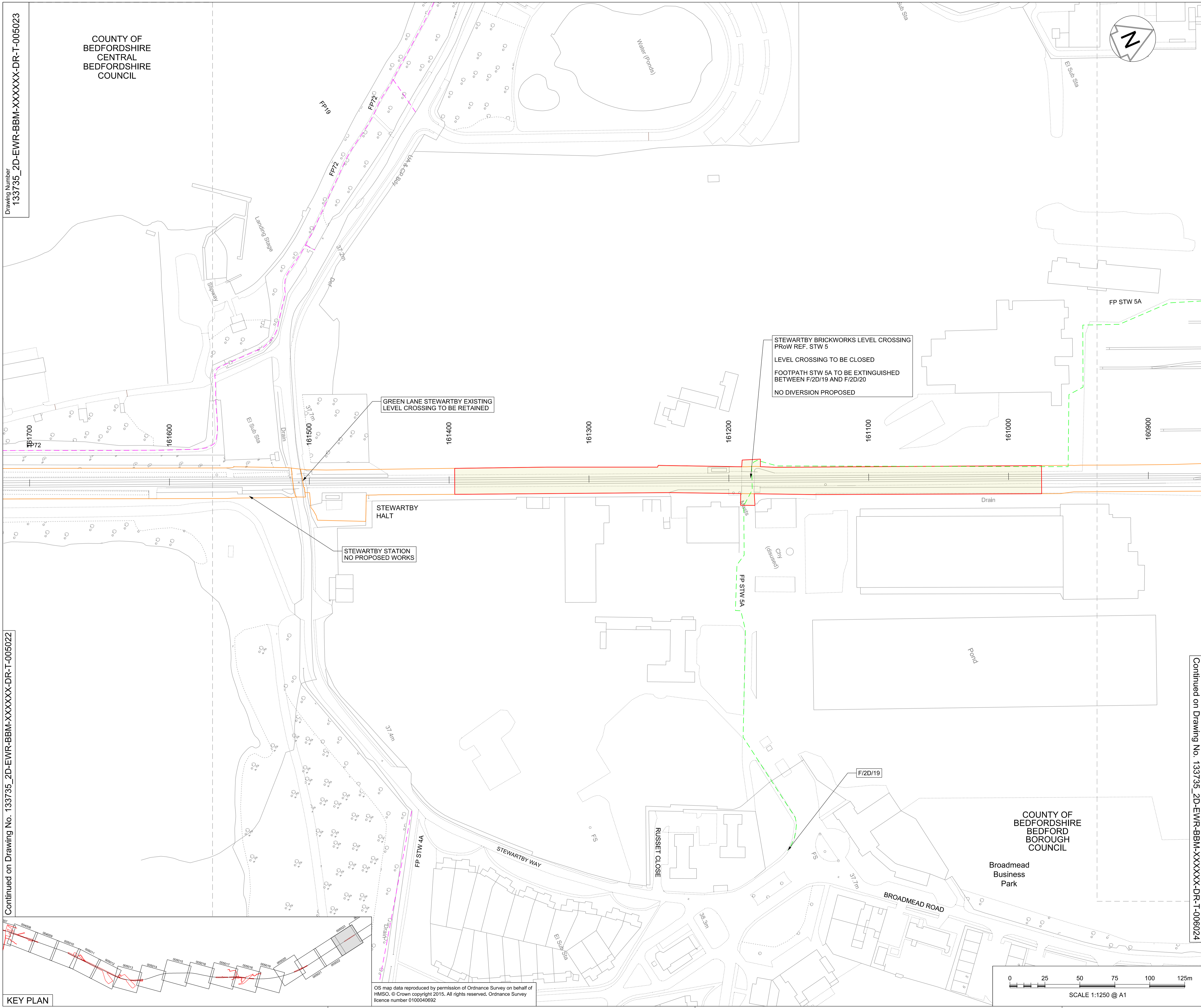

OS map data reproduced by permission of Ordnance Survey on behalf of HMSO. © Crown copyright 2015. All rights reserved. Ordnance Survey licence number 0100040692

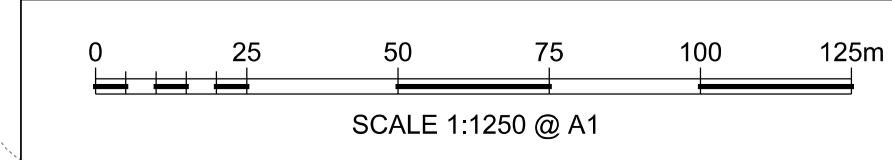

NETWORK RAIL (EAST WEST
RAIL WESTERN SECTION
PHASE 2) ORDER

- KEY**
- APPLICATION BOUNDARY AND EXTENT OF PERMANENT AND TEMPORARY PROPOSED WORKS
 - EXISTING NETWORK RAIL BOUNDARY
 - EXTENT OF OVERLAP WITH ADJACENT SHEET
 - EXISTING FOOTPATH TO BE EXTINGUISHED
 - EXISTING FOOTPATH
 - F/2X/XX PERMANENT PROW EXTINGUISHMENT POINT
 - WORKSITE AND ACCESS FOR CONSTRUCTION

Rev	Date	Description of Revisions	Desd	Chkd	Appr
A01	17/12/17	Approved for Consultation	S.M.	P.P.	C.M.

Status: Accepted for Outline Design Suitability: A4



Project: East West Rail (Western Section) Phase 2

Drawing Title: Scheme Drawing Bletchley to Bedford

Designed	Sam McLelland	Signed	S. McLelland	Date	17/12/17
Drawn	Grace Newey	Signed	G. Newey	Date	07/12/16
Checked	Paul Panini	Signed	P. Panini	Date	17/12/17
Approved	Colin Murphy	Signed	C. Murphy	Date	17/12/17

Scale(s): 1:1250
Design Package Risk Classification: ELR & Project Chainage: Normal

Alternative Reference: EWR2-CEP-DRG-PBL-445023
Drawing Number: 133735_2D-EWR-BBM-XXXXXX-DR-T-005023