

Drawing Number  
133735\_2D-EWR-BBM-XXXXXX-DR-T-005017

Continued on Drawing No. 133735\_2D-EWR-BBM-XXXXXX-DR-T-005016

KEY PLAN

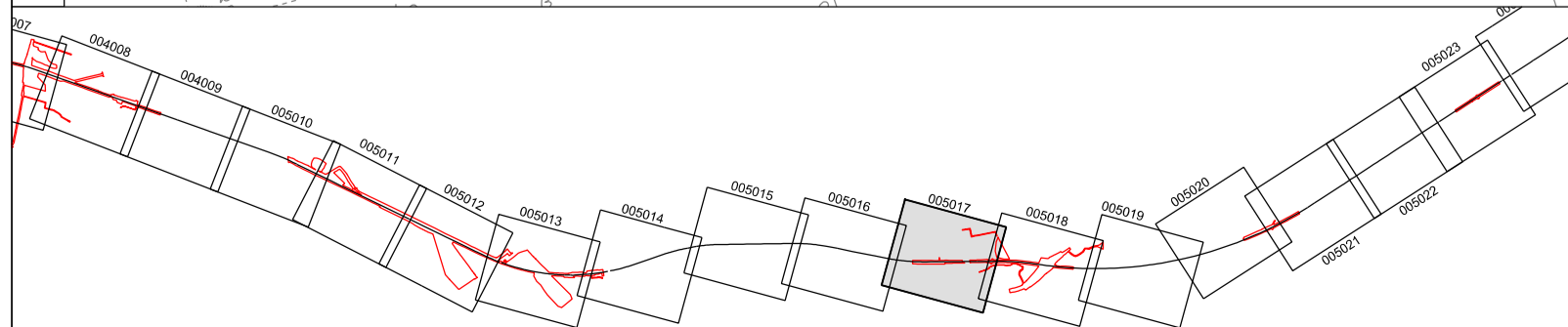

OS map data reproduced by permission of Ordnance Survey on behalf of HMSO. © Crown copyright 2015. All rights reserved. Ordnance Survey licence number 0100040692

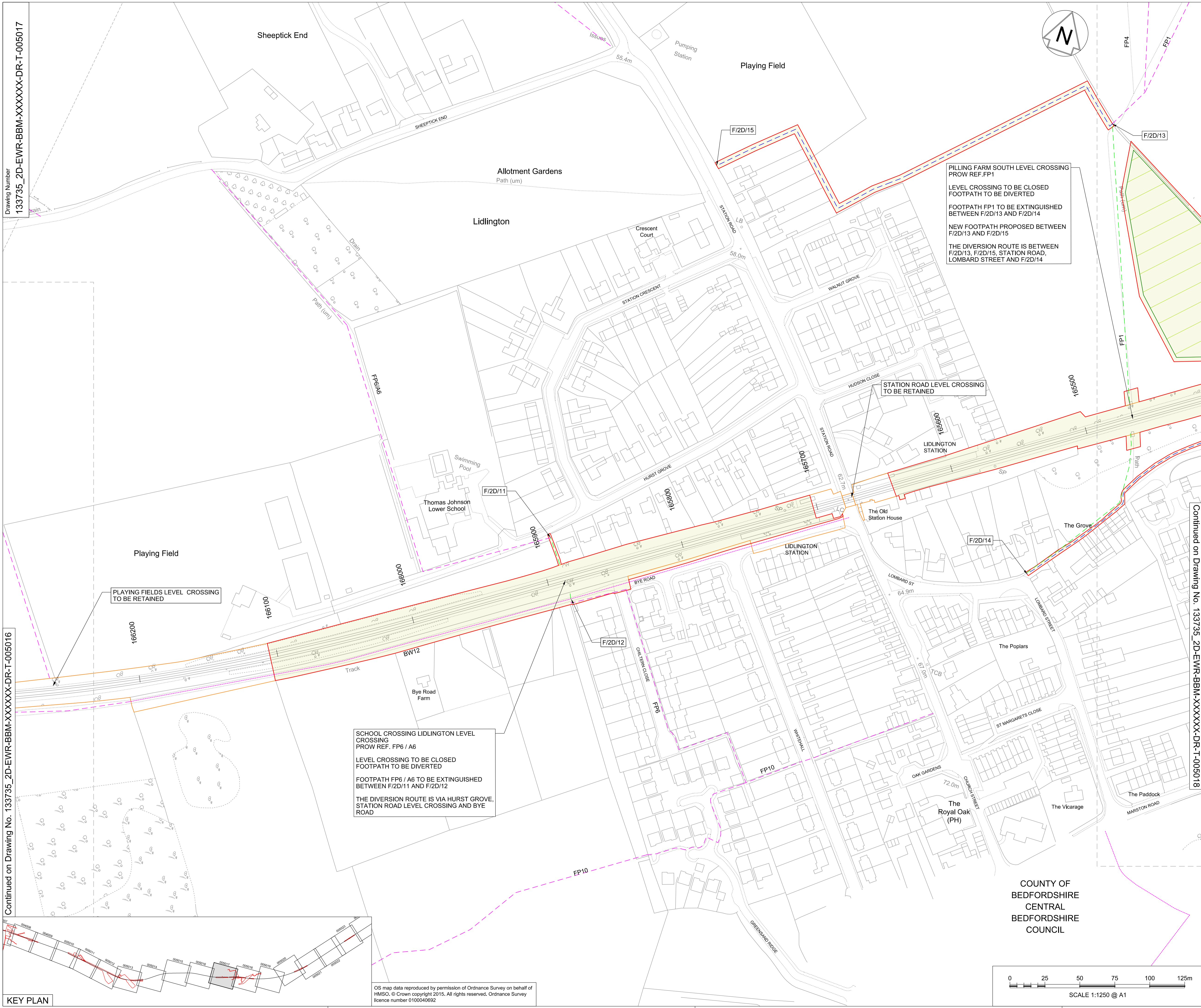

PILLING FARM SOUTH LEVEL CROSSING  
PROW REF. FP1  
LEVEL CROSSING TO BE CLOSED  
FOOTPATH TO BE DIVERTED  
FOOTPATH FP1 TO BE EXTINGUISHED  
BETWEEN F/2D/13 AND F/2D/14  
NEW FOOTPATH PROPOSED BETWEEN  
F/2D/13 AND F/2D/15  
THE DIVERSION ROUTE IS BETWEEN  
F/2D/13, F/2D/15, STATION ROAD,  
LOMBARD STREET AND F/2D/14

STATION ROAD LEVEL CROSSING  
TO BE RETAINED

PLAYING FIELDS LEVEL CROSSING  
TO BE RETAINED

SCHOOL CROSSING LIDLINGTON LEVEL  
CROSSING  
PROW REF. FP6 / A6  
LEVEL CROSSING TO BE CLOSED  
FOOTPATH TO BE DIVERTED  
FOOTPATH FP6 / A6 TO BE EXTINGUISHED  
BETWEEN F/2D/11 AND F/2D/12  
THE DIVERSION ROUTE IS VIA HURST GROVE,  
STATION ROAD LEVEL CROSSING AND BYE  
ROAD

COUNTY OF  
BEDFORDSHIRE  
CENTRAL  
BEDFORDSHIRE  
COUNCIL

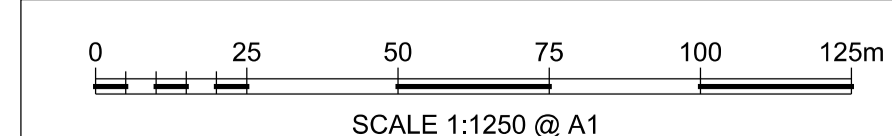

### NETWORK RAIL (EAST WEST RAIL WESTERN SECTION PHASE 2) ORDER

- KEY**
- APPLICATION BOUNDARY AND EXTENT OF PERMANENT AND TEMPORARY PROPOSED WORKS
  - PERMANENT LAND TO BE ACQUIRED FOR ENGINEERING WORKS
  - EXISTING NETWORK RAIL BOUNDARY
  - WORKSITE AND ACCESS FOR CONSTRUCTION
  - EXTENT OF OVERLAP WITH ADJACENT SHEET
  - EXISTING FOOTPATH TO BE EXTINGUISHED
  - EXISTING BRIDLEWAY
  - PROPOSED FOOTPATH
  - PROPOSED BRIDLEWAY
  - F/2X/XX PERMANENT PROW EXTINGUISHMENT POINT
  - PERMANENT LAND TO BE ACQUIRED FOR ENVIRONMENTAL MITIGATION

Rev	Date	Description of Revisions	Dsrd	Chkd	Appr	S.M.	P.P.	C.M.
A01	17/12/17	Approved for Consultation						
Accepted for Outline Design								A4



### East West Rail (Western Section) Phase 2

### Scheme Drawing Bletchley to Bedford

Designed	Sam McLelland	Signed	S. McLelland	Date	17/12/17
Drawn	Grace Newey	Signed	G. Newey	Date	07/12/16
Checked	Paul Panini	Signed	P. Panini	Date	17/12/17
Approved	Colin Murphy	Signed	C. Murphy	Date	17/12/17

Scale(s) 1:1250  
Design Package Risk Classification Normal

Alternative Reference EWR2-CEP-DRG-PBL-445017  
Drawing Number 133735\_2D-EWR-BBM-XXXXXX-DR-T-005017