

Drawing Number
133735_2B-EWR-OXD-097300-DR-T-002007

Continued on Drawing No.
133735_2B-EWR-OXD-098080-DR-T-002005 / 002006

COUNTY OF BUCKINGHAMSHIRE
AYLESBURY VALE
CLAYDON/QUANTON

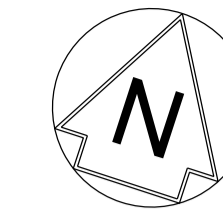

NETWORK RAIL (EAST WEST
RAIL WESTERN SECTION
PHASE 2) ORDER

- KEY**
- APPLICATION BOUNDARY AND EXTENT OF PERMANENT AND TEMPORARY PROPOSED WORKS
 - PERMANENT LAND TO BE ACQUIRED FOR ENGINEERING WORKS
 - PERMANENT LAND TO BE ACQUIRED FOR ENVIRONMENT MITIGATION
 - EXISTING NETWORK RAIL BOUNDARY
 - WORKSITE AND ACCESS FOR CONSTRUCTION
 - EXTENT OF OVERLAP WITH ADJACENT SHEET
 - EARTHWORKS
 - EXISTING DRAINAGE WORKS REQUIRED
 - x PROW TO BE EXTINGUISHED PERMANENTLY AND MAY BE TEMPORARILY CLOSED DURING CONSTRUCTION
 - x PROPOSED FOOTPATH
 - x PROW THAT MAY BE TEMPORARILY CLOSED DURING CONSTRUCTION
 - EXISTING FOOTPATH
 - F/2B/XXX PERMANENT PROW EXTINGUISHMENT POINT
 - HP-SG SGN HIGH PRESSURE GAS MAIN

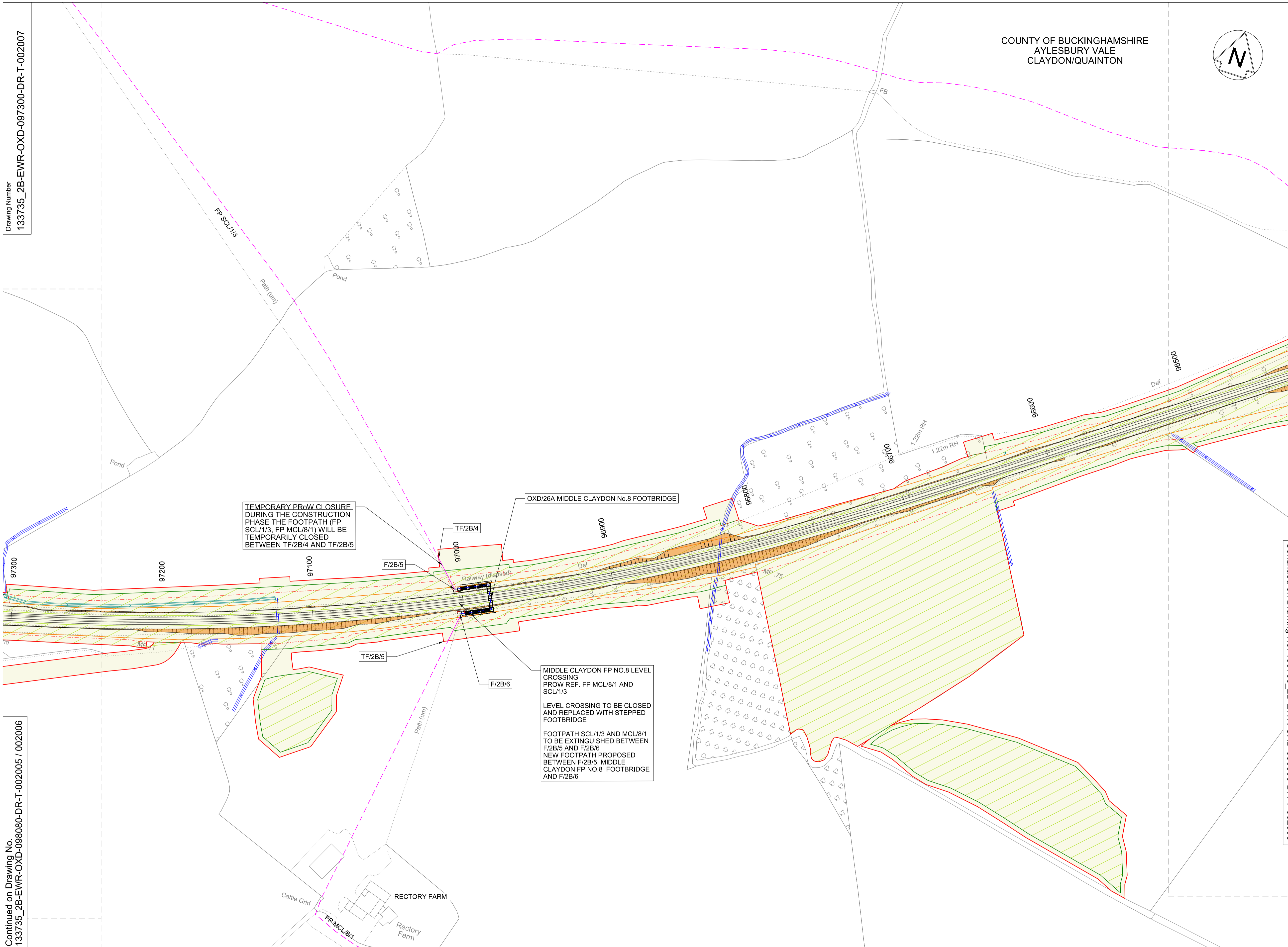

TEMPORARY PROW CLOSURE DURING THE CONSTRUCTION PHASE THE FOOTPATH (FP SCL/1/3, FP MCL/8/1) WILL BE TEMPORARILY CLOSED BETWEEN TF/2B/4 AND TF/2B/5

MIDDLE CLAYDON FP NO.8 LEVEL CROSSING PROW REF. FP MCL/8/1 AND SCL/1/3
LEVEL CROSSING TO BE CLOSED AND REPLACED WITH STEPPED FOOTBRIDGE
FOOTPATH SCL/1/3 AND MCL/8/1 TO BE EXTINGUISHED BETWEEN F/2B/5 AND F/2B/6
NEW FOOTPATH PROPOSED BETWEEN F/2B/5, MIDDLE CLAYDON FP NO.8 FOOTBRIDGE AND F/2B/6

Continued on Drawing No. 133735_2B-EWR-OXD-096500-DR-T-002008

Rev	Date	Description of Revisions	Dsmd	Chkd	Appr	Status	Suitability
A01	17/12/17	Approved for Consultation					
							A4



East West Rail
(Western Section)
Phase 2

Scheme Drawing
Claydon Junction to Bletchley

Designed	Sam McLelland	Signed	S. McLelland	Date	17/12/17
Drawn	Grace Newey	Signed	G. Newey	Date	07/12/16
Checked	Paul Panini	Signed	P. Panini	Date	17/12/17
Approved	Colin Murphy	Signed	C. Murphy	Date	17/12/17

Scale(s) 1:1250
Design Package Risk Classification Normal
Alternative Reference EWR2-CEP-DRG-PBL-422007
Drawing Number 133735_2B-EWR-OXD-097300-DR-T-002007

Sheet 22 of 127
Revision A01

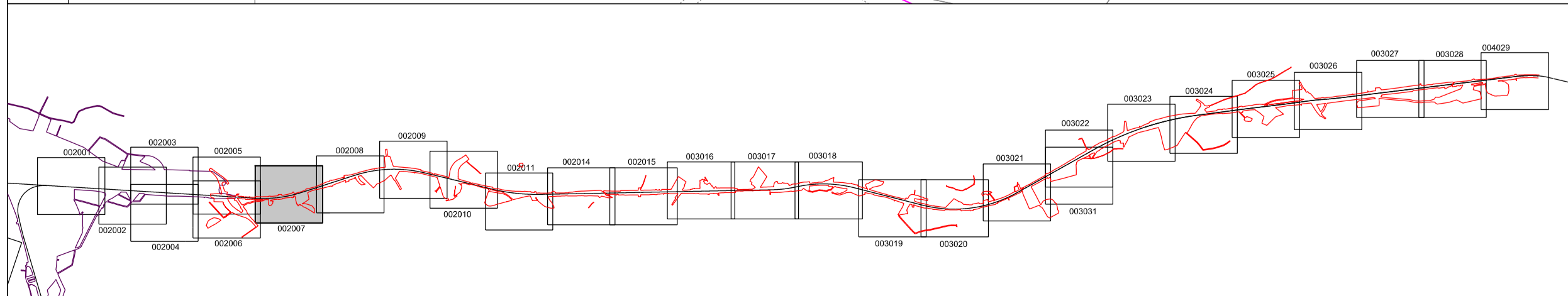

KEY PLAN

OS map data reproduced by permission of Ordnance Survey on behalf of HMSO. © Crown copyright 2015. All rights reserved. Ordnance Survey licence number 0100040692

